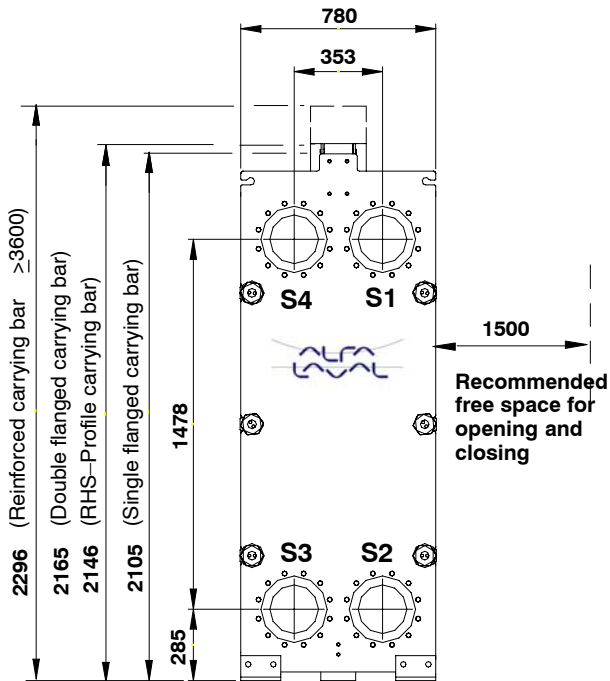
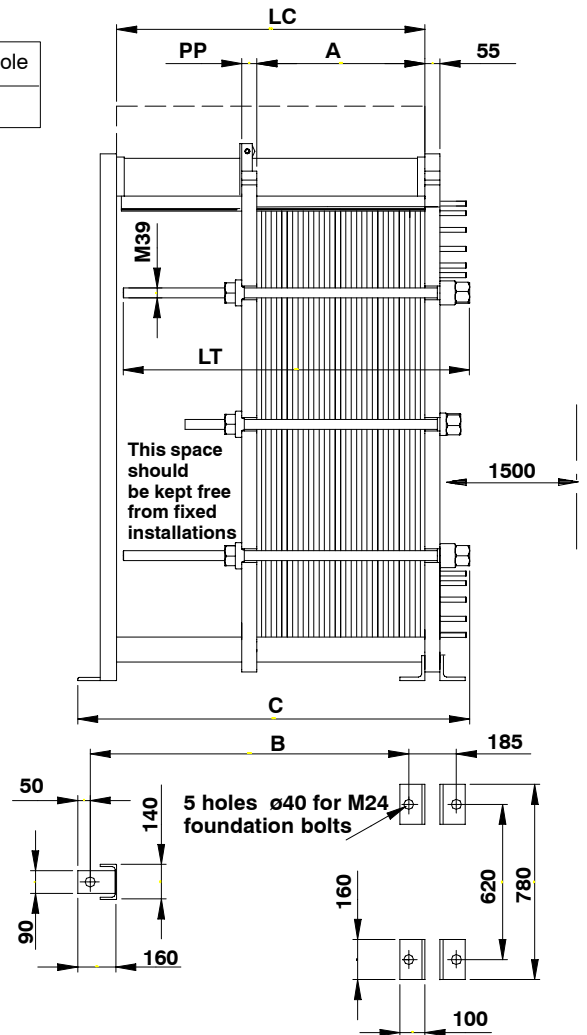



Plate heat exchanger type T20-BFM ALS



PP 0/4 Hole
50/55



CONNECTION TYPES

1. Unlined connection

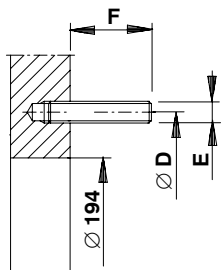

2. Sheet lining

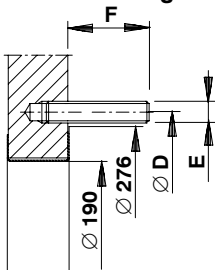

3. Rubber spool

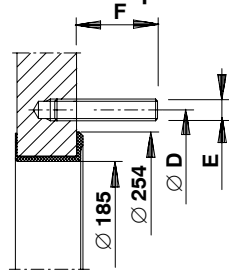

STANDARD	D	E	F	No. of stud bolts
DIN PN10	295	M20	104	8
ASME Cl. 150	298.4	3/4"-10 UNC	96	8
JIS 10K	290	M20	64	12

Connection standard DIN PN10 also valid for EN1092 PN10 and GB PN10 and GOST PN10

CONNECTION LOCATIONS

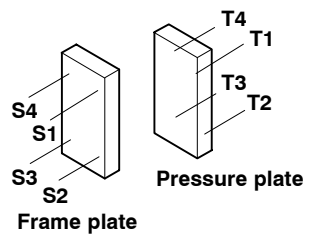

LOCATION	MEDIA	CONN.TYPE

QUOTATION NO.		
ORDER NO.		
ITEM NO.		
CALCULATION NO.		
PREPARED	CHECKED	APPROVED

Date	No.	Edition	Dept.
0605	32200-15261	1	PC CHE