

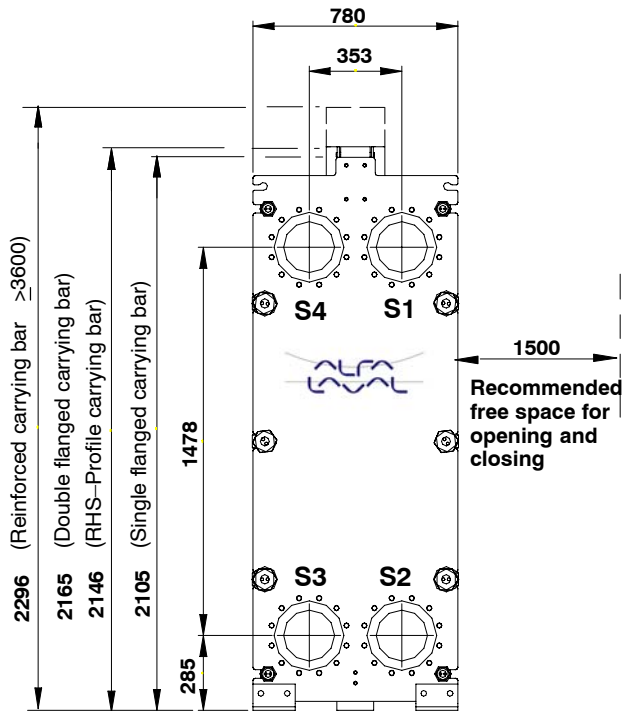

# Plate heat exchanger type T20-BFG

## ALS



PP 0/4 Hole  
60/70

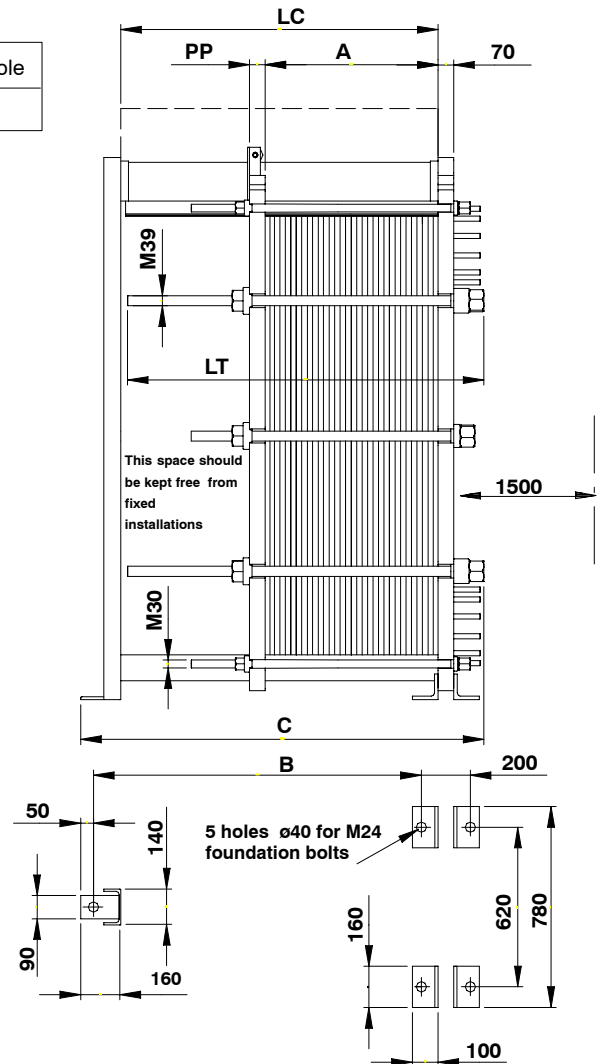

### CONNECTION TYPES

#### 1. Unlined connection

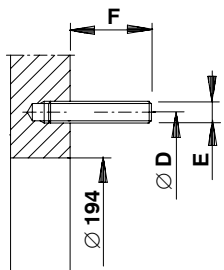

#### 2. Sheet lining

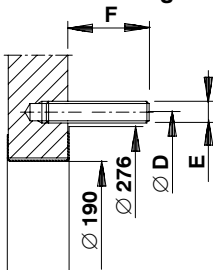

#### 3. Rubber spool

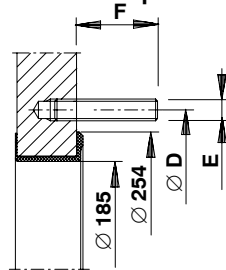

STANDARD	D	E	F	No. of stud bolts
DIN PN16	295	M20	104	12
ASME Cl. 150	298.4	3/4"-10 UNC	96	8
JIS 16K	305	M22	72	12

### CONNECTION LOCATIONS

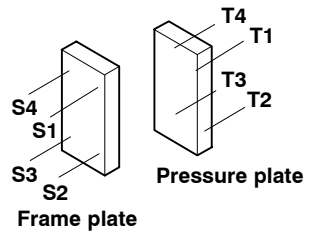

LOCATION	MEDIA	CONN.TYPE

Connection standard DIN PN16 also valid for EN1092 PN16 and GB PN16 and GOST PN16

QUOTATION NO.		
ORDER NO.		
ITEM NO.		
CALCULATION NO.		
PREPARED	CHECKED	APPROVED

Date	No.	Edition	Dept.
0605	32200-15291	1	PC CHE